

# BS Aqua Series Roller Chain

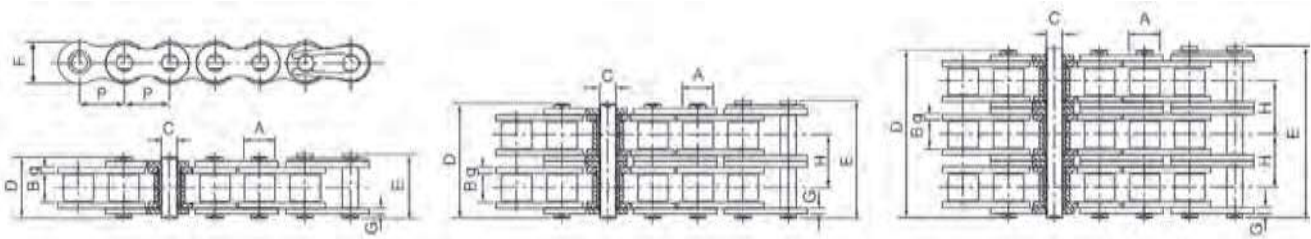

ISO Chain No.	Pitch	Roller diameter	Width between inner plates		Pin diameter		Pin length		Inner plate height	Plate thickness	Transverse pitch	Minimum tensile strength	Average tensile strength	Weight per meter
	P	A	B	C	D	E	F	g/G	H					
	mm	mm	mm	mm	mm	mm	mm	mm	mm	mm	mm	kN	kN	kg/m
<b>SIMPLEX</b>														
05B-1	8.000	5.00	3.00	2.31	8.20	8.90	7.10	0.8	-	-	5.00	5.90	0.20	
06B-1	9.525	6.35	5.72	3.28	13.15	14.10	8.20	1.30	-	-	9.00	10.40	0.41	
08B-1	12.700	8.51	7.75	4.45	16.70	18.20	11.80	1.60	-	-	18.00	19.40	0.69	
10B-1	15.875	10.16	9.65	5.08	19.50	20.90	14.70	1.70	-	-	22.40	27.50	0.93	
12B-1	19.050	12.07	11.68	5.72	22.50	24.20	16.00	1.85	-	-	29.00	32.20	1.15	
16B-1	25.400	15.88	17.02	8.28	36.10	37.40	21.00	4.15/3.1	-	-	60.00	72.80	2.71	
20B-1	31.750	19.05	19.56	10.19	41.30	45.00	26.40	4.5/3.5	-	-	95.00	106.70	3.70	
24B-1	38.100	25.40	25.40	14.63	53.40	57.80	33.20	6.0/4.8	-	-	160.00	178.00	7.10	
28B-1	44.450	27.94	30.99	15.90	65.10	69.50	36.70	7.5/6.0	-	-	200.00	222.00	8.50	
32B-1	50.800	29.21	30.99	17.81	66.00	71.00	42.00	7.0/6.0	-	-	250.00	277.50	10.25	
<b>DUPLEX</b>														
06B-2	9.525	6.35	5.72	3.28	23.40	24.40	8.20	1.30	10.24	16.90	18.70	0.77		
08B-2	12.700	8.51	7.75	4.45	31.20	32.20	11.80	1.60	13.92	32.00	38.70	1.34		
10B-2	15.875	10.16	9.65	5.08	36.10	37.50	14.70	1.70	16.59	44.50	56.20	1.84		
12B-2	19.050	12.07	11.68	5.72	42.00	43.60	16.00	1.85	19.46	57.80	66.10	2.31		
16B-2	25.400	15.88	17.02	8.28	68.00	69.30	21.00	4.15/3.1	31.88	106.00	133.00	5.42		
20B-2	31.750	19.05	19.56	10.19	77.80	81.50	26.40	4.5/3.5	36.45	170.00	211.20	7.20		
24B-2	38.100	25.40	25.40	14.63	101.70	106.20	33.20	6.0/4.8	48.36	280.00	319.20	13.40		
28B-2	44.450	27.94	30.99	15.90	124.60	129.10	36.70	7.5/6.0	59.56	360.00	406.80	16.60		
<b>TRIPLEX</b>														
08B-3	12.700	8.51	7.75	4.45	45.10	46.10	11.80	1.60	13.92	47.50	57.80	2.03		
10B-3	15.875	10.16	9.65	5.08	53.8	55.15	14.70	1.70	16.59	66.80	84.50	2.71		
12B-3	19.050	12.07	11.68	5.72	61.50	63.10	16.00	1.85	19.46	86.70	101.80	3.46		
16B-3	25.400	15.88	17.02	8.28	101.9	105.25	21.00	4.15/3.1	31.88	126.80	203.70	7.75		

## Straight Side Plate Chain

Chain	Pitch	Roller diameter	Width between inner plates	Pin diameter	Pin length		Inner plate height	Plate thickness	Minimum tensile strength	Average tensile strength	Weight per meter
	P	A	B	C	D	E	F	g/G	kN	kN	kg/m
12B-1GL	19.050	12.07	11.68	5.72	22.50	24.20	16.00	1.85	29.00	32.2	1.32



## Feature

Excellent corrosion resistance without plating same strength and working load values as standard chain No hydrogen embrittlement by surface treatment.

## Results of corrosion resistant tests

### Salt spray test

CHAINS	Hour for Rust developed(hours)
Special surface treated	1000 No rust
Glossy chromating	72~96
Colored chromating	120~240
Molten zinc plating	120~240

### Salt spray test

CHAINS	Hour for Rust developed(hours)
Nickel plated	48
Special surface treated	600~840
Made of SUS304 stainless steel	above 840 No rust

## Applications

Outdoor service  
Sea water applications  
Stacking crane, Car parking

## Applicable Chains

#40~#240  
Attachment chain is available.

## Purpose of Special surface treatment

Linkplate : for anticorrosion  
Other parts : for anticorrosion and to reduce friction

## Caution

For the food products industry where the chain may be exposed to direct food contact, stainless steel chain is recommended.

## Applicable Chains

SY40AP~SY240AP  
Attachment chain is available.  
For identification, a suffix is added to the chain numbers.

## SY AQUA CHAINS

08B-1	40-1
08B-2	40-2
10B-1	50-1
10B-2	50-2
12B-1	60-1
12B-2	60-2
16B-1	80-1
16B-2	100-1
20B-1	C2060H

THE ULTIMATE ROLLER CHAIN **LONG LIFE SERIES**

**New AQUA-series  
ROLLER CHAIN**

BS STANDARD ROLLER CHAINS  
ANSI STANDARD ROLLER CHAINS  
HEAVY-SERIES ROLLER CHAINS  
S-SERIES ROLLER CHAINS  
SUPER ROLLER CHAINS  
OIL-FIELD CHAINS  
ROLLERLESS CHAINS  
STRAIGHT SIDEBAR CHAINS  
DOUBLE PITCH ROLLER CHAINS etc.

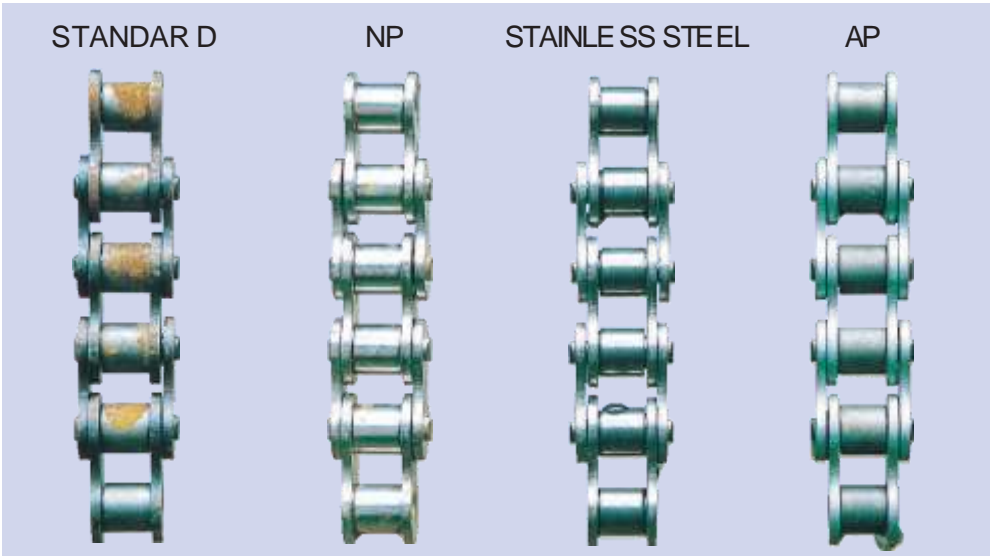

Open air,  
splashed water  
morning&evening

3days after

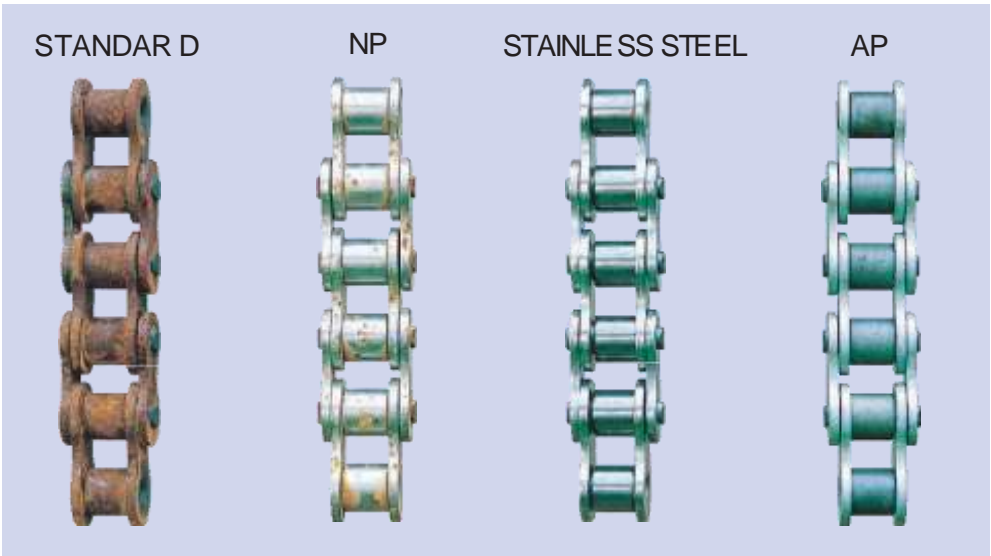

Open air,  
splashed water  
morning&evening

15days after



Indoors,  
splashed  
5%salty water  
morning&evening

15days after