

## Deep Groove Ball Bearings series R..., R..ZZ, R..2RS

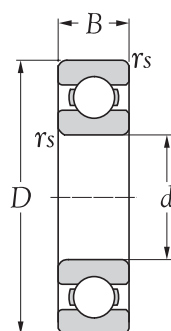

Open

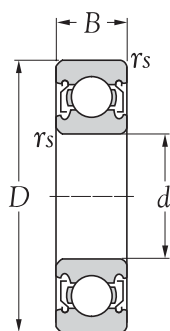

Shielded type  
(ZZ)

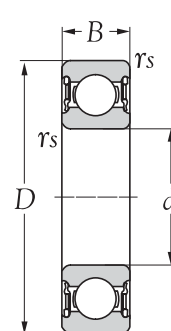

Sealed type  
(2RS)

Boundary dimensions				Basic load ratings		Limiting speeds		Bearing numbers			Mass
mm				dynamic	static	grease	oil	open	with shields	with seals	kg
$d$	$D$	$B$	$r_s \text{ min}^0$	$C_r$	$C_{or}$	rpm					(approx.)
3.175	9.525	3.968 3.968	0.3	630	218	56000	67000	R2	R2 ZZ	R2 2RS	0.0012 0.0014
4.762	12.700	3.968 4.978	0.3	1310	490	41000	48000	R3	R3 ZZ	R3 2RS	0.0022 0.0024
6.350	15.875	4.978 4.978	0.4	1480	615	36000	43000	R4	R4 ZZ	R4 2RS	0.0040 0.0044
9.525	22.225	5.556 7.144	1.0	3300	1400	31000	37000	R6	R6 ZZ	R6 2RS	0.0136 0.0140
12.700	28.575	6.350 7.938	1.0	3950	2250	26000	31000	R8	R8 ZZ	R8 2RS	0.0165 0.0180
15.875	34.925	7.140 8.730	1.0	4600	2800	21000	25000	R10	R10 ZZ	R10 2RS	0.0340 0.0370
19.050	41.275	7.938 11.112	1.0	7250	4450	16000	21000	R12	R12 ZZ	R12 2RS	0.0440 0.0470
22.225	47.625	9.525 12.700	1.0	7250	4950	12000	16000	R14	R14 ZZ	R14 2RS	0.0700 0.0720
25.400	50.800	9.525 12.700	1.0	8250	5450	11000	15000	R16	R16 ZZ	R16 2RS	0.0810 0.0850
28.575	53.975	9.525 12.700	1.0	9600	6260	10000	13000	R18	R18 ZZ	R18 2RS	0.0860 0.0900
31.750	57.150	9.525 12.700	1.0	10800	7520	9000	11000	R20	R20 ZZ	R20 2RS	0.0900 0.0950
34.925	63.500	11.113 14.288	1.0	12280	8500	7000	8500	R22	R22 ZZ	R22 2RS	0.1010 0.1050
38.100	66.675	11.113 14.288	1.0	13150	9450	6000	7500	R24	R24 ZZ	R24 2RS	0.1360 0.1400

Note: 1) These values are the allowable minimum dimensions of the chamfer dimension  $r$ .