

SDTZ Rod Ends are manufactured with a bronze liner on the spherical surface of the outer ring and a chromium liner on the surface of the inner ring.

The surface of the rod body is zinc plated and the housing containing a lubrication hole or grease nipple.

Sliding surfaces are bronze and steel.

All rod ends are available in either left or right hand thread (Add the suffix 'L' for left hand thread).

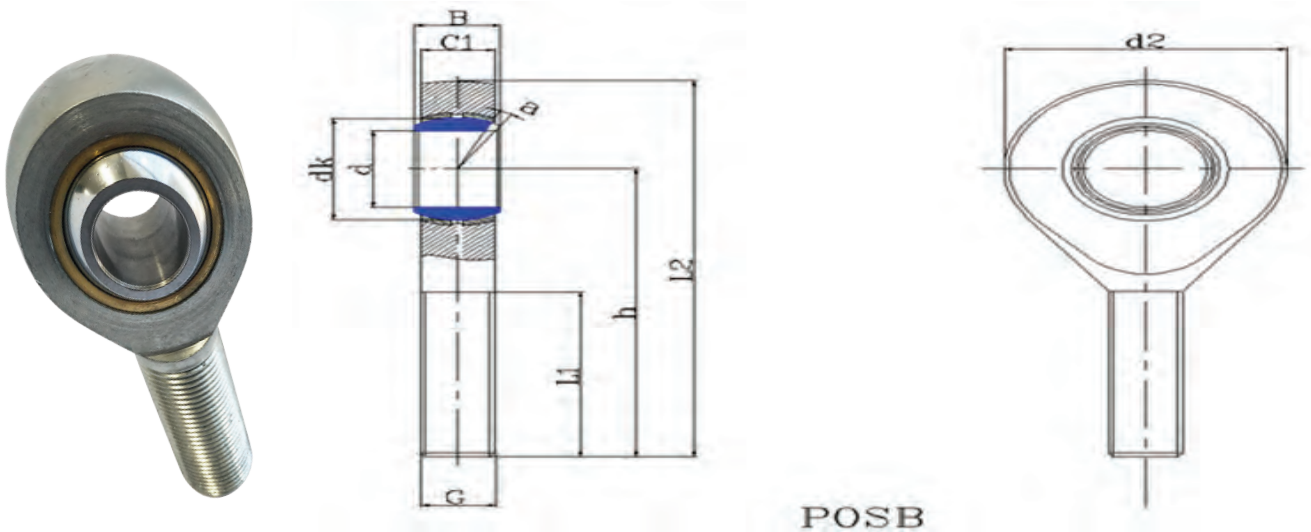

POSB Series

| Bearing Number | Dimensions | | | | | | | | | | | | | | Load ratings(KN) | | Weight (kg) |
|----------------|------------|-------|-------|-------|-------|---------|--------|-------|--------|----|-----|-----|-------|------|------------------|--------|-------------|
| | d | B | dk | C1 | d2 | G | h | L3 | L4 | L5 | W | d3 | d4 | a° ≈ | Dynamic | Static | |
| POSB3 | 4.826 | 7.93 | 11.10 | 6.35 | 15.88 | 10-32 | 26.97 | 19.05 | 39.70 | 10 | 3.4 | 3.8 | 0.013 | 10 | 3.4 | 4.6 | 0.015 |
| POSB4 | 6.350 | 9.53 | 12.70 | 7.14 | 19.05 | 1/4-28 | 33.32 | 25.40 | 49.20 | 13 | 4.5 | 6.6 | 0.022 | 13 | 4.5 | 7.7 | 0.025 |
| POSB5 | 7.938 | 11.10 | 15.88 | 8.74 | 22.23 | 5/16-24 | 34.93 | 31.75 | 58.72 | 10 | 6.9 | 8.4 | 0.037 | 10 | 6.9 | 8.4 | 0.036 |
| POSB6 | 9.525 | 12.70 | 18.26 | 10.31 | 25.40 | 3/8-24 | 41.28 | 31.75 | 61.93 | 9 | 9.4 | 10 | 0.055 | 9 | 9.4 | 10 | 0.061 |
| POSB7 | 11.113 | 14.28 | 20.62 | 11.10 | 28.58 | 7/16-20 | 46.02 | 34.93 | 68.28 | 11 | 11 | 13 | 0.078 | 11 | 11 | 13 | 0.081 |
| POSB8 | 12.700 | 15.88 | 23.81 | 12.70 | 33.32 | 1/2-20 | 53.98 | 38.10 | 78.59 | 9 | 15 | 19 | 0.12 | 9 | 15 | 19 | 0.133 |
| POSB10 | 15.875 | 19.05 | 28.58 | 14.27 | 38.10 | 5/8-18 | 63.50 | 41.28 | 85.73 | 11 | 20 | 21 | 0.18 | 11 | 20 | 21 | 0.190 |
| POSB12 | 19.050 | 22.23 | 33.32 | 17.45 | 44.45 | 3/4-16 | 73.03 | 44.45 | 95.25 | 10 | 29 | 29 | 0.29 | 10 | 29 | 29 | 0.285 |
| POSB16 | 25.400 | 34.93 | 47.63 | 25.40 | 69.85 | 5/4-12 | 104.78 | 53.98 | 139.70 | 14 | 60 | 101 | 1.1 | 14 | 60 | 101 | 1.000 |