

## Flange Units SUCFL200-TF SERIES

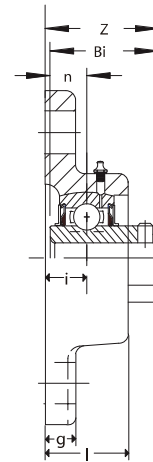
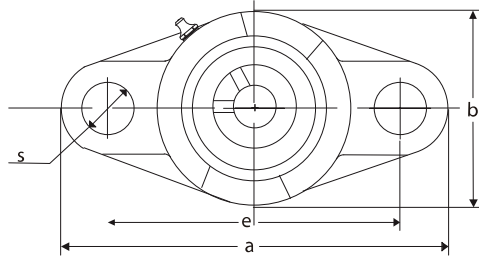

Stainless Steel Bearings  
with Thermoplastic Housings  
Material : Housing-Polybutlene (PBT)  
Bearing-Stainless Steel AISI440C

UNIT NO.	Shaft Dia.		Dimension (in) (mm)										Bolt Used		BEARING NO.	HOUSING NO.	Weight kg.			
	In	mm	a	e	i	g	l	s	b	z	Bi	n	t	in				mm		
SUCFL201-TF 201-8TF 202-TF 202-10TF 203-TF 204-TF 204-12TF	1/2 5/8 3/4	12 15 17 20																SUC201 201-8 202 202-10 203 204 204-12	FL204-TF	0.50
SUCFL205-TF 205-14TF 205-15TF 205-16TF	7/8 15/16 1	25	5 1/8 130	3 57/64 99	5/8 16	1/2 13	1 11/16 27	5/8 16	2 11/16 68	1 15/32 35.7	1.3425 34.1	0.5630 14.3	1 9/16 39.5	1/2	14		SUC205 205-14 205-15 205-16	FL205-TF	0.70	
SUCFL206-TF 206-18TF 206-19TF 206-20TF	1 1/8 1 3/16 1 1/4	30	5 13/16 148	4 39/64 117	45/64 18	1/2 13	1 7/32 31	5/8 16	3 5/32 80	1 37/64 40.2	1.5000 38.1	0.6260 15.9	1 23/32 44.0	1/2	14		SUC206 206-18 206-19 206-20	FL206-TF	0.98	
SUCFL207-TF 207-20TF 207-21TF 207-22TF 207-23TF	1 1/4 1 5/16 1 3/8 1 7/16	35	6 11/32 161	5 1/8 130	3/4 19	9/16 14	1 11/32 34	5/8 16	3 17/32 90	1 3/4 44.4	1.6890 42.9	0.6890 17.5	1 29/32 48.5	1/2	14		SUC207 207-20 207-21 207-22 207-23	FL207-TF	1.35	
SUCFL208-TF 208-24TF 208-25TF	1 1/2 1 9/16	40	6 7/8 175	5 43/64 144	53/64 21	9/16 14	1 13/32 36	5/8 16	3 15/16 100	2 1/64 51.2	1.9370 49.2	0.7480 19.0	2 5/32 55.0	1/2	14		SUC208 208-24 208-25	FL208-TF	1.69	
SUCFL209-TF 209-26TF 209-27TF 209-28TF	1 5/8 1 11/16 1 3/4	45	7 13/32 188	5 53/64 148	55/64 22	19/32 15	1 1/2 38	3/4 19	4 1/4 108	2 1/16 52.2	1.9370 49.2	0.7480 19.0	2 7/32 56.0	5/8	16		SUC209 209-26 209-27 209-28	FL209-TF	2.04	
SUCFL210-TF 210-30TF 210-31TF	1 7/8 1 15/16	50	7 3/4 197	6 3/16 157	55/64 22	19/32 15	1 9/16 40	3/4 19	4 17/32 115	2 5/32 54.6	2.0315 51.6	0.7480 19.0	2 5/16 58.5	5/8	16		SUC210 210-30 210-31	FL210-TF	2.30	
SUCFL211-TF 211-32TF 211-34TF 211-35TF	2 2 1/8 2 3/16	55	8 13/16 224	7 1/4 184	63/64 25	23/32 18	1 11/16 43	3/4 19	5 1/8 130	2 19/64 58.4	2.1890 55.6	0.8740 22.2	2 15/32 62.5	5/8	16		SUC211 211-32 211-34 211-36	FL211-TF	3.30	
SUCFL212-TF 212-36TF 212-38TF 212-39TF	2 1/4 2 3/8 2 7/16	60	9 27/32 250	7 61/64 202	1 9/64 29	23/32 18	1 7/8 48	29/32 23	5 1/2 140	2 45/64 68.7	2.5630 65.1	1.0000 25.4	2 7/8 73.0	3/4	20		SUC212 212-36 212-38 212-39	FL212-TF	4.30	