

**NEEDLE ROLLER BEARINGS**

**FULL COMPLIMENT WITH  
NEEDLE ROLLERS (KRV SERIES)  
OR CYLINDRICAL ROLLERS, STUD-TYPE  
(NUKR SERIES)  
METRIC SERIES**

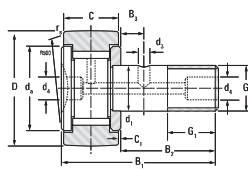

**KRV.2SK  
KRV.SK (D ≤ 19 mm (0.7480 in))**

Outer Dia. mm in	d <sub>1</sub> h7 mm in	D mm in	C mm in	r <sub>1</sub> max. mm in	B <sub>1</sub> mm in	B <sub>2</sub> mm in	B <sub>3</sub> mm in	G <sub>1</sub> mm in	d <sub>2</sub> mm in	d <sub>3</sub> mm in	Thread		
											G	C <sub>1</sub>	d <sub>s</sub>
16 0.6299	6 0.2362	16 0.6299	11 0.433	0.3	29.2 1.110	16 0.630		8 0.315	4 0.157		M6x1	0.6 0.34	11 0.433
19 0.7480	8 0.3150	19 0.7480	11 0.433	0.3	32.2 1.268	20 0.787		10 0.394	4 0.157		M8x1.25	0.6 0.34	13 0.512
22 0.8661	10 0.3937	22 0.8661	12 0.472	0.3	36.2 1.425	23 0.906		12 0.472	4 0.157		M10x1	0.6 0.34	15 0.591
26 1.0238	10 0.3937	26 1.0238	12 0.472	0.3	36.2 1.425	23 0.906		12 0.472	4 0.157		M10x1	0.6 0.34	15 0.591
30 1.1811	12 0.4724	30 1.1811	14 0.551	0.6	40.2 1.583	25 0.984	6 0.236	13 0.512	6 0.236	3 0.118	M12x1.5	0.6 0.34	21 0.827
32 1.2598	12 0.4724	32 1.2598	14 0.551	0.6	40.2 1.583	25 0.984	6 0.236	13 0.512	6 0.236	3 0.118	M12x1.5	0.6 0.34	21 0.827
35 1.3780	15 0.5909	35 1.3780	18 0.708	0.6	52 2.047	32.5 1.280	8 0.315	17 0.669	6 0.236	3 0.118	M16x1.5	0.8 0.31	25 0.984
40 1.5748	18 0.7087	40 1.5748	20 0.787	1	58 2.283	36.5 1.437	8 0.315	19 0.748	6 0.236	3 0.118	M18x1.5	0.8 0.31	27 1.063
47 1.8504	20 0.7874	47 1.8504	24 0.945	1	66 2.598	40.5 1.594	9 0.354	21 0.827	6 0.236	4 0.157	M20x1.5	0.8 0.31	33 1.299
52 2.0472	20 0.7874	52 2.0472	24 0.945	1	66 2.598	40.5 1.594	9 0.354	21 0.827	6 0.236	4 0.157	M20x1.5	0.8 0.31	33 1.299
62 2.4403	24 0.9449	62 2.4403	29 1.142	1	80 3.150	48.5 1.909	11 0.433	25 0.984	8 0.315	4 0.157	M24x1.5	0.8 0.31	45 1.772
72 2.8346	24 0.9449	72 2.8346	29 1.142	1.1	80 3.150	48.5 1.909	11 0.433	25 0.984	8 0.315	4 0.157	M24x1.5	0.8 0.31	51 2.008
80 3.1496	30 1.1811	80 3.1496	35 1.378	1.4	100 3.937	63 2.480	15 0.591	32 1.260	8 0.315	4 0.157	M30x1.5	1.0 0.39	52 2.047
90 3.5433	30 1.1811	90 3.5433	35 1.378	1.4	100 3.937	63 2.480	15 0.591	32 1.260	8 0.315	4 0.157	M30x1.5	1.0 0.39	52 2.047

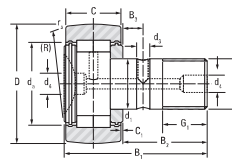

**NUKR.2SK**

Crowned Designation	Load Ratings						Tightening Torque N-m lb-in	Speed Rating Grease m/s <sup>1</sup>	Approx. Wt. kg lb
	As a Bearing		As a Track Roller						
	Dynamic	Static	Dynamic	Static	Dynamic	Static			
	C	C <sub>0</sub>	C <sub>0</sub>	F <sub>100%</sub>	F <sub>100%</sub>	F <sub>100%</sub>			
KRV16.SK	6.90 1550	6.40 1690	5.11 1150	3.49 780	6.29 1410	7 62.0	5700	0.219 0.342	
KRV19.SK	8.68 1920	11.0 2470	5.66 1270	4.13 930	7.43 1670	15 142	4300	0.321 0.363	
KRV22.2SK	8.45 2120	14.3 3210	6.32 1420	5.04 1130	8.07 2040	28 248	3400	0.266 0.191	
KRV26.2SK	8.45 2120	14.3 3210	7.20 1640	6.69 1890	12.7 2860	28 248	3400	0.269 0.136	
KRV30.2SK	13.1 3010	19.8 4450	9.95 2210	8.28 2070	15.7 3520	45 398	2800	0.287 0.182	
KRV32.2SK	13.1 3010	19.8 4450	10.4 2340	11.3 2540	17.4 3910	45 398	2800	0.208 0.216	
NUKR35.2SK	24.7 5500	29.1 6610	16.2 3640	10.1 2270	16.3 3620	53.2 471	6100	0.179 0.275	
NUKR40.2SK	26.6 5980	33.3 7490	18.7 4200	15.8 3370	23.9 5370	77.5 686	5000	0.259 0.351	
NUKR47.2SK	41.4 9310	53.2 12000	26.1 6320	20.5 4610	32.7 7350	109 965	4500	0.380 0.338	
NUKR52.2SK	45.8 10300	63.1 14200	29.6 6650	22.2 4950	35.4 7960	109 965	3700	0.461 1.016	
NUKR62.2SK	62.7 14100	83.1 18700	40.9 9190	28.6 6650	47.2 10620	193 1708	3200	0.790 1.142	
NUKR72.2SK	68.9 15500	97.8 22000	46.1 10400	36.6 8900	63.1 14200	193 1708	2600	1.040 2.293	
NUKR80.2SK	95.1 21400	130 29200	66.7 15700	63.2 14200	101 22700	390 3452	2900	1.559 3.417	
NUKR90.2SK	95.1 21400	130 29200	77.8 17500	67.8 22000	128 28600	390 3452	2900	2.029 4.453	