

IKO Inch Series Heavy Duty Cam Followers Full Complement Type/With Hexagon Hole

Selectable product specifications

Material	No symbol	Carbon steel
	F	Stainless steel
Roller guide type	No symbol	Caged
	V	Full complement
Seal structure	No symbol	Shield type
	UU	Sealed type
Shape of outer ring	No symbol	Cylindrical outer ring
	R	Crowned outer ring

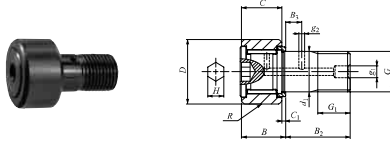

CRH---VBR

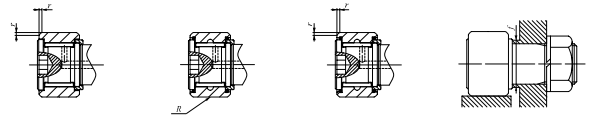

CRH---VB

CRH---VBUUR

CRH---VBUU

Stud dia. mm (inch)	Identification number				Mass (Ref.) g	D	C	d <sub>1</sub>	G UNF	G <sub>1</sub>
	Shield type		Sealed type							
	With crowned outer ring	With cylindrical outer ring	With crowned outer ring	With cylindrical outer ring						
6.350 ( $\frac{1}{4}$ )	CRH 8-1 VBR	CRH 8-1 VB	CRH 8-1 VBUUR	CRH 8-1 VBUU	12	12.700	9.525	6.350	$\frac{1}{4}$ -28	6.350
	CRH 9 VBR	CRH 9 VB	CRH 9 VBUUR	CRH 9 VBUU	15	14.288	9.525	6.350	$\frac{1}{4}$ -28	6.350
7.938 ( $\frac{5}{16}$ )	CRH 10-1 VBR	CRH 10-1 VB	CRH 10-1 VBUUR	CRH 10-1 VBUU	23	15.875	11.112	7.938	$\frac{5}{16}$ -24	7.938
	CRH 11 VBR	CRH 11 VB	CRH 11 VBUUR	CRH 11 VBUU	27	17.462	11.112	7.938	$\frac{5}{16}$ -24	7.938
11.112 ( $\frac{7}{16}$ )	CRH 12 VBR	CRH 12 VB	CRH 12 VBUUR	CRH 12 VBUU	39	19.050	12.700	11.112	$\frac{3}{8}$ -20	9.525
	CRH 14 VBR	CRH 14 VB	CRH 14 VBUUR	CRH 14 VBUU	49	22.225	12.700	11.112	$\frac{3}{8}$ -20	9.525
15.875 ( $\frac{1}{2}$ )	CRH 16 VBR	CRH 16 VB	CRH 16 VBUUR	CRH 16 VBUU	93	25.400	15.875	15.875	$\frac{1}{2}$ -18	12.700
	CRH 18 VBR	CRH 18 VB	CRH 18 VBUUR	CRH 18 VBUU	109	28.575	15.875	15.875	$\frac{1}{2}$ -18	12.700
19.050 ( $\frac{3}{4}$ )	CRH 20 VBR	CRH 20 VB	CRH 20 VBUUR	CRH 20 VBUU	176	31.750	19.050	19.050	$\frac{1}{2}$ -16	15.875
	CRH 22 VBR	CRH 22 VB	CRH 22 VBUUR	CRH 22 VBUU	200	34.925	19.050	19.050	$\frac{1}{2}$ -16	15.875
22.225 ( $\frac{7}{8}$ )	CRH 24 VBR	CRH 24 VB	CRH 24 VBUUR	CRH 24 VBUU	296	38.100	22.225	22.225	$\frac{3}{4}$ -14	19.050
	CRH 26 VBR	CRH 26 VB	CRH 26 VBUUR	CRH 26 VBUU	329	41.275	22.225	22.225	$\frac{3}{4}$ -14	19.050
25.400 (1)	CRH 28 VBR	CRH 28 VB	CRH 28 VBUUR	CRH 28 VBUU	463	44.450	25.400	25.400	1-14 UNS	22.225
	CRH 30 VBR	CRH 30 VB	CRH 30 VBUUR	CRH 30 VBUU	508	47.625	25.400	25.400	1-14 UNS	22.225
28.575 ( $1\frac{1}{8}$ )	CRH 32 VBR	CRH 32 VB	CRH 32 VBUUR	CRH 32 VBUU	722	50.800	31.750	28.575	$1\frac{1}{8}$ -12	25.400
	CRH 36 VBR	CRH 36 VB	CRH 36 VBUUR	CRH 36 VBUU	858	57.150	31.750	28.575	$1\frac{1}{8}$ -12	25.400
31.750 ( $1\frac{1}{4}$ )	CRH 40 VBR	CRH 40 VB	CRH 40 VBUUR	CRH 40 VBUU	1 260	63.500	38.100	31.750	$1\frac{1}{4}$ -12	28.575
	CRH 44 VBR	CRH 44 VB	CRH 44 VBUUR	CRH 44 VBUU	1 460	69.850	38.100	31.750	$1\frac{1}{4}$ -12	28.575
38.100 ( $1\frac{1}{2}$ )	CRH 48 VBR	CRH 48 VB	CRH 48 VBUUR	CRH 48 VBUU	2 100	76.200	44.450	38.100	$1\frac{1}{2}$ -12	31.750
	CRH 52 VBR	CRH 52 VB	CRH 52 VBUUR	CRH 52 VBUU	2 390	82.550	44.450	38.100	$1\frac{1}{2}$ -12	31.750
44.450 ( $1\frac{3}{4}$ )	CRH 56 VBR	CRH 56 VB	CRH 56 VBUUR	CRH 56 VBUU	3 240	88.900	50.800	44.450	$1\frac{3}{4}$ -12UN	34.925
50.800 (2)	CRH 64 VBR	CRH 64 VB	CRH 64 VBUUR	CRH 64 VBUU	4 960	101.600	57.150	50.800	2-12 UN	38.100

Remarks 1. Models with a stud diameter d<sub>1</sub> of 7.938 mm or less have no oil hole. Other models are provided with one oil hole each on the outside surface and end surface of the stud.  
2. Provided with prepacked grease.  
3. A nut is supplied with the stud.

Boundary dimensions mm(inch)										Mounting dimension f mm(inch)	Maximum tightening torque N·m	Basic dynamic load rating C N	Basic static load rating C <sub>0</sub> N	
B max	B <sub>2</sub>	B <sub>3</sub>	C <sub>1</sub>	g <sub>1</sub>	g <sub>2</sub>	H	R	r	Min. mm(inch)					
11.1(0.44)	15.875	—	—	0.794	—	—	—	3.175	180.7	0.397	8.334	3.4	4 710	5 410
11.1(0.44)	15.875	—	—	0.794	—	—	—	3.175	180.7	0.397	8.334	3.4	4 710	5 410
12.8(0.50)	19.050	—	—	0.794	—	—	—	3.175	200.8	0.397	11.112	6.8	6 340	8 530
12.8(0.50)	19.050	—	—	0.794	—	—	—	3.175	200.8	0.397	11.112	6.8	6 340	8 530
14.6(0.57)	22.225	6.350	0.794	4.762	2.381	4.762	250.10	0.794	13.494	17.6	8 710	17.6	8 710	12 300
14.6(0.57)	22.225	6.350	0.794	4.762	2.381	4.762	250.10	0.794	13.494	17.6	8 710	17.6	8 710	12 300
17.9(0.70)	25.400	6.350	1.588	4.762	2.381	6.350	300.12	1.191	18.256	57.8	13 100	57.8	13 100	22 700
17.9(0.70)	25.400	6.350	1.588	4.762	2.381	6.350	300.12	1.588	18.256	57.8	13 100	57.8	13 100	22 700
21.0(0.83)	31.750	7.938	1.588	4.762	2.381	6.350	360.14	1.588	24.209	103	23 600	103	23 600	31 700
21.0(0.83)	31.750	7.938	1.588	4.762	2.381	6.350	360.14	1.588	24.209	103	23 600	103	23 600	31 700
24.3(0.96)	38.100	9.525	1.588	4.762	2.381	7.938	500.30	1.588	26.988	162	28 200	162	28 200	40 100
24.3(0.96)	38.100	9.525	1.588	4.762	2.381	7.938	500.30	1.588	26.988	162	28 200	162	28 200	40 100
27.4(1.08)	44.450	11.112	1.588	4.762	2.381	7.938	500.30	1.588	32.941	258	35 300	258	35 300	55 600
27.4(1.08)	44.450	11.112	1.588	4.762	2.381	7.938	500.30	1.588	32.941	258	35 300	258	35 300	55 600
34.2(1.35)	50.800	12.700	1.588	4.762	3.175	11.112	600.24	1.588	37.306	356	45 700	356	45 700	80 600
34.2(1.35)	50.800	12.700	1.588	4.762	3.175	11.112	600.24	1.588	37.306	356	45 700	356	45 700	80 600
40.0(1.57)	57.150	14.288	1.588	4.762	3.175	12.700	760.30	2.381	40.878	500	61 400	500	61 400	116 000
40.0(1.57)	57.150	14.288	1.588	4.762	3.175	12.700	760.30	2.381	40.878	500	61 400	500	61 400	116 000
46.4(1.83)	63.500	15.875	1.588	6.350	3.175	15.050	760.30	2.381	51.991	892	77 600	892	77 600	172 000
46.4(1.83)	63.500	15.875	1.588	6.350	3.175	15.050	760.30	2.381	51.991	892	77 600	892	77 600	172 000
52.8(2.08)	69.850	17.462	1.588	6.350	3.175	18.050	760.30	2.381	58.288	1 450	111 000	1 450	111 000	239 000
59.4(2.34)	88.900	19.050	1.588	6.350	3.175	19.050	760.30	2.381	64.691	2 190	142 000	2 190	142 000	317 000