

"Why compete against your supplier when you can be our partner"

12B-1-2-3 Taper Lock		Teeth	de	dp	dm	A	Bush	Type	App. Kg	dm	A	Bush	Type	App. Kg	dm	A	Bush	Type	App. Kg	
		12	815	736	60	244	1210	1	OA	-	-	-	-	-	-	-	-	-	-	-
		13	878	7959	60	2540	1210	1	041	OA	254	1210	OA	OA	-	-	-	-	-	-
		14	936	8561	70	2540	1610	1	OA	-	-	-	-	-	-	-	-	-	-	-
		15	998	9163	70	2540	1610	1	054	-	30.10	1610	3	090	-	498	1615	5	OA	-
		16	1055	9765	75	2540	1610	1	OA	-	30.10	1610	3	OA	-	-	-	-	-	-
		17	1119	1037	76	2540	1610	1	082	-	30.10	1610/1615	3	1.25	-	498	1615/2017	5	OA	-
		18	1179	1097	90	31.75	1610/2012	1	091	90	31.75	2012	2	OA	-	-	-	-	-	-
		19	1239	1158	90	31.75	2012	1	1.00	90	31.75	2012	2	1.81	-	498	2012	5	OA	-
		20	130	1218	90	44.45	2012	1	1.00	108	44.45	2517	2	OA	-	-	-	-	-	-
		21	136	1278	102	44.45	2517	1	1.18	108	44.45	2517	2	2.50	-	498	2517	5	OA	-
		22	142	1339	102	44.45	2517	1	1.27	108	44.45	2517	2	OA	-	-	-	-	-	-
	Pinions	mm	23	1481	1399	108	44.45	2517	1	1.37	108	44.45	2517	2	3.07	-	498	2517	5	OA
Tooth Radius r3		24	154.1	1459	108	44.45	2517	1	1.50	108	44.45	2517	2	OA	-	-	-	-	-	-
Radius Width C		25	160.2	152	108	44.45	2517	1	1.74	108	44.45	2517	2	3.63	-	498	2517	5	OA	-
Tooth Width B1	11.1	26	165.9	158	108	44.45	2517	1	OA	108	44.45	2517	2	OA	-	-	-	-	-	-
		27	172.3	164.1	108	44.45	2517	1	1.80	108	44.45	2517	2	4.20	140	5080	3020	4	OA	-
Chain	mm	28	178	170	108	44.45	2517	1	OA	108	44.45	2517	2	OA	-	-	-	-	-	-
Pitch	19.05	29	184.1	176.2	108	44.45	2517	1	OA	108	44.45	2517	2	OA	-	-	-	-	-	-
Inside	11.68	30	190.4	182.3	108	44.45	2517	1	2.32	140	5080	2517	2	5.04	140	5080	3020	4	OA	-
Roller ϕ	12.07	32	202.5	194.4	108	44.45	2517	1	2.48	OA	OA	2517	OA	OA	-	-	-	-	-	-
		34	214.6	206.5	108	44.45	2517	1	OA	-	-	-	-	-	-	-	-	-	-	-
		35	221	212.5	108	44.45	2517	1	OA	-	-	-	-	-	-	-	-	-	-	-
		36	226.8	218.6	108	44.45	2517	1	OA	-	-	-	-	-	-	-	-	-	-	-
		38	238.9	230.1	108	44.45	2517	1	3.36	140	5080	3020	2	8.40	140	5080	3020	4	OA	-
		45	283.2	273.1	108	44.45	2517	1	3.98	140	5080	3020	2	-	-	-	-	-	-	
		57	355.9	345.8	108	44.45	2517	1	8.76	140	5080	3020	2	19.48	160	5080	3020	4	OA	-
		76	471.1	461	108	44.45	2517	1	11.68	140	5080	3020	2	29.52	160	5080	3020	4	OA	-
		95	586.2	576.2	108	44.45	2517	1	14.60	140	5080	3020	2	34.40	-	-	-	-	-	-
		114	701.4	691.4	140	50.80	3020	1	17.52	160	76.20	3030	2	39.28	-	-	-	-	-	-

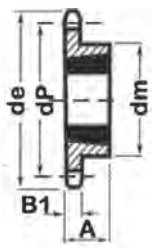

Type 1

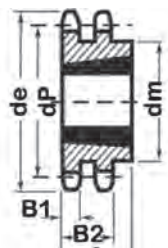

Type 2

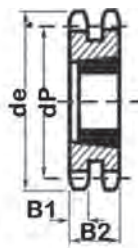

Type 3

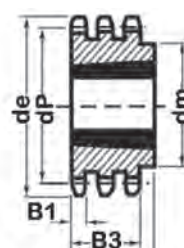

Type 4

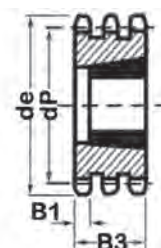

Type 5

British Standard Taper Locks



"Australia's Only Genuine Wholesaler"

16B-1-2-3 Taper Lock		Teeth	de	dp	dm	A	Bush	Type	App. Kg	dm	A	Bush	Type	App. Kg	dm	A	Bush	Type
		12	109	98.14	73	25.4	1610	1	0A	-	-	-	-	-	-	-	-	-
		13	117.7	106.1	73	38.10	1610/1615	1	1.27	0A	47.7	2012	0A	0A	-	-	-	-
		14	125	114	76	38.10	1610	1	0A	-	-	-	-	-	-	-	-	-
		15	133.7	122.2	76	38.10	1610/1615	1	1.45	-	47.7	2012	3	2.04	-	47.7	2012	5
		16	141.8	130.2	76	38.10	1615/2012	1	1.55	-	47.7	2517	3	0A	-	-	-	-
		17	149.8	138.2	90	32	2012/2517	1	1.69	-	47.7	2517	3	2.50	-	79.6	2517	5
		18	157.8	146.3	108	44.45	2517	1	1.46	-	47.7	2517	3	0A	-	-	-	-
		19	165.9	154.4	108	44.45	2517	1	2.14	-	47.7	2517	3	3.18	-	79.6	3030	5
		20	173.9	162.4	108	44.45	2517	1	2.72	-	47.7	2517	3	0A	-	-	-	-
		21	182	170.4	110	44.45	2517	1	2.95	140	50.80	3020	2	2.95	-	79.6	3030/3535	5
Pinions	mm	22	190.1	178.5	110	44.45	2517	1	3.18	140	50.80	3020	2	0A	-	-	-	-
Tooth Radius r3		23	198.1	186.5	110	44.45	2517	1	3.40	140	50.80	3020	2	5.48	-	89	3525/3535	5
Radius Width C		24	206.2	194.6	110	44.45	2517	1	3.63	140	50.80	3020	2	0A	-	-	-	-
Tooth Width B1	16.2	25	214.2	202.7	110	44.45	2517	1	3.90	140	50.80	3020	2	7.72	-	89	3535	5
		26	221.6	210.7	110	44.45	2517	1	0A	140	50.80	3020	2	0A	-	-	-	-
Chain	mm	27	230.4	218.8	110	44.45	2517	1	4.31	140	50.80	3020	2	10.22	-	89	3535	5
Pitch	25.4	28	237.7	226.8	110	44.45	2517	1	0A	140	50.80	3020	2	0A	-	-	-	-
Inside	17.02	29	245.8	234.9	120	44.45	2517/3020	1	0A	140	50.80	3020	2	0A	-	-	-	-
Roller ø	15.88	30	254.6	243	120	44.45	2517/3020	1	5.44	140	50.80/76.20	3020/3030	2	11.35	175	89	3525/3535	4
		32	270.7	259.1	140	50.8	3020	1	0A	-	-	-	-	-	-	-	-	-
		33	278.5	267.2	140	50.8	3020	1	0A	-	-	-	-	-	-	-	-	-
		35	294.9	283.4	140	50.80	3020	1	7.12	-	-	-	-	-	-	-	-	
		38	319.2	307.6	140	50.80	3020	1	8.85	160	76.20	3020/3030	2	21.79	178	89	3535	4
		45	377.9	364.1	140	50.80	2517/3020	1	12.25	0A	76.2	3020	0A	0A	-	-	-	-
		57	474.9	461.1	140	50.80	3020	1	19.16	175	86.90	3525	2	27.24	216	102	4040	4
		76	628.4	614.7	140	50.80	3020	1	28.55	175	86.90	3535	2	37.68	216	102	4030/4040	4
		95	782	768.2	140	50.80	3020	1	41.58	-	-	-	-	-	-	-	-	
		114	935.6	921.8	140	50.80	3030	1	56.15	-	-	-	-	-	-	-	-	

<p>Type 1</p>	<p>Type 2</p>	<p>Type 3</p>	<p>Type 4</p>	<p>Type 5</p>
----------------------	----------------------	----------------------	----------------------	----------------------