

## Ball bearings series 622..2RS

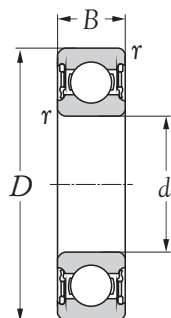

Sealed type  
(2RS)

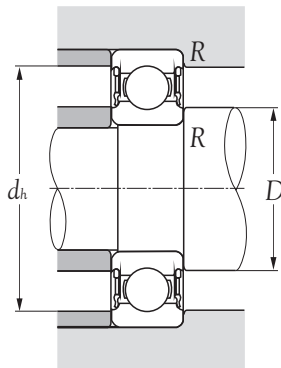

Boundary dimensions mm				Basic load ratings dynamic static N		Speed rating grease rpm	Bearing numbers	Abutment and fillet dimensions mm				Mass kg. (approx.)
d	D	B	r <sub>s min</sub> <sup>1)</sup>	C <sub>o</sub>	C <sub>or</sub>	D <sub>s min</sub>		D <sub>s max</sub>	d <sub>h max</sub>	R <sub>max</sub>		
10	30	14	0.6	5070	2360	17000	<b>62200 2RS</b>	14.0	14.5	26.0	0.6	0.040
12	32	14	0.6	6890	3100	15000	<b>62201 2RS</b>	16.0	16.0	28.0	0.6	0.045
15	35	14	0.6	7800	3750	13000	<b>62202 2RS</b>	19.0	19.0	31.0	0.6	0.054
17	40	16	0.6	9560	4750	12000	<b>62203 2RS</b>	21.0	21.0	36.0	0.6	0.083
20	47	18	1.0	12700	6550	10000	<b>62204 2RS</b>	25.0	25.5	42.0	1.0	0.130
25	52	18	1.0	14000	7800	8500	<b>62205 2RS</b>	30.0	31.0	47.0	1.0	0.150
30	62	20	1.0	19500	11200	7500	<b>62206 2RS</b>	35.0	37.0	57.0	1.0	0.240
35	72	23	1.1	25500	15300	6300	<b>62207 2RS</b>	41.5	43.5	65.5	1.0	0.370
40	80	23	1.1	30700	19000	5600	<b>62208 2RS</b>	46.5	49.5	73.5	1.0	0.440
45	85	23	1.1	33200	21600	5000	<b>62209 2RS</b>	51.5	54.0	78.5	1.0	0.480
50	90	23	1.1	35100	23200	4800	<b>62210 2RS</b>	56.5	58.0	83.5	1.0	0.520
55	100	25	1.5	43600	29000	4300	<b>62211 2RS</b>	63.0	65.0	92.0	1.5	0.700
60	110	28	1.5	47500	32500	4000	<b>62212 2RS</b>	68.0	71.0	102.0	1.5	0.970

Note: 1) These values are the allowable minimum dimensions of the chamfer dimension r.

Remark: [ Precision ] - Class 0 (JIS)

[ Cage ] - Steel

[ Grease ] - Shell Alvania S2

If you require more individual technical information for each of above bearing model, please enter **KSM** web-site:

[Http://www.minamiguchi-bearings.com](http://www.minamiguchi-bearings.com), click into the bearing no., to obtain data sheet.