

"Why compete against your supplier when you can be our partner"

| 08B-1-2 Taper Lock | | Teeth | de | dp | Simplex | | | | Duplex | | | | |
|--------------------|-------|-------|-----|-------|-----------|---|-------|------|---------|------|---|-------|------|
| | | | | | dm | A | Bush | Type | App. Kg | dm | A | Bush | Type |
| 14 | 61.9 | 57.07 | 45 | 22.23 | 1008 | 1 | 0.18 | - | - | - | - | - | |
| 15 | 65.9 | 61.09 | 45 | 22.23 | 1008 | 1 | 0.18 | 46 | 22.23 | 1008 | 2 | 0.18 | |
| 16 | 69.9 | 65.1 | 45 | 22.23 | 1008/1108 | 1 | 0.23 | 50 | 22 | 1008 | 2 | 0A | |
| 17 | 74 | 69.11 | 60 | 25.40 | 1108/1210 | 1 | 0.23 | 56 | 25.40 | 1210 | 2 | 0.27 | |
| 18 | 78 | 73.14 | 62 | 25.40 | 1210 | 1 | 0.27 | 60 | 25 | 1210 | 2 | 0A | |
| 19 | 82 | 77.16 | 63 | 25.40 | 1210 | 1 | 0.32 | 62 | 25.40 | 1210 | 2 | 0.36 | |
| 20 | 86 | 81.19 | 71 | 25.40 | 1210/1610 | 1 | 0.41 | 66 | 25 | 1610 | 2 | 0A | |
| 21 | 90.1 | 85.22 | 71 | 25.40 | 1610 | 1 | 0.45 | 70 | 25.40 | 1610 | 2 | 0.46 | |
| 22 | 94.1 | 89.24 | 71 | 25.40 | 1610 | 1 | 0.50 | 76 | 25 | 1610 | 2 | 0A | |
| 23 | 98.1 | 93.27 | 76 | 25.40 | 1610 | 1 | 0.59 | 79 | 25.40 | 1610 | 2 | 0.59 | |
| 24 | 102.1 | 97.29 | 76 | 25.40 | 1610 | 1 | 0.73 | 84 | 25 | 2012 | 2 | 0A | |
| 25 | 106.2 | 101.3 | 76 | 25.40 | 1610 | 1 | 0.74 | 87 | 31.75 | 2012 | 2 | 0.77 | |
| 26 | 110.2 | 105.4 | 76 | 25.40 | 1610 | 1 | 0.76 | 87 | 32 | 2012 | 2 | 0A | |
| 27 | 114.2 | 109.4 | 76 | 25.40 | 1610 | 1 | 0.78 | 87 | 31.75 | 2012 | 2 | 0.95 | |
| 28 | 118.3 | 113.4 | 76 | 25.40 | 2012 | 1 | 0.80 | 87 | 32 | 2012 | 2 | 0A | |
| 29 | 112.3 | 117.5 | 76 | 25.40 | 2012 | 1 | 0.81 | 87 | 32 | 2012 | 2 | 0A | |
| 30 | 126.3 | 121.5 | 90 | 31.75 | 2012 | 1 | 0.82 | 87 | 32 | 2012 | 2 | 1.59 | |
| 32 | 134.4 | 129.6 | 90 | 31.75 | 2012 | 1 | 0.87 | - | - | - | - | - | |
| 35 | 146.5 | 141.7 | 9.0 | 31.5 | 2012 | 1 | 0.95 | - | - | - | - | - | |
| 37 | 151.0 | 145.7 | - | - | - | - | - | 87 | 32 | 2012 | 2 | 2.85 | |
| 38 | 158.6 | 153.8 | 90 | 31.75 | 2012 | 1 | 1.23 | 100 | 32 | 2012 | 2 | 3.18 | |
| 45 | 188.6 | 182.1 | 100 | 31.75 | 2012 | 1 | 1.46 | 100 | 32 | 2012 | 2 | 3.95 | |
| 48 | 200.7 | 194.2 | 100 | 31.75 | 2012 | 1 | 1.55 | - | - | - | - | - | |
| 50 | 208.8 | 202.3 | 110 | 31.75 | 2012 | 1 | 0A | - | - | - | - | - | |
| 57 | 233.1 | 230.5 | 110 | 31.75 | 2012 | 1 | 2.60 | 110 | 31.75 | 2012 | 2 | 7.56 | |
| 76 | 313.9 | 307.3 | 110 | 31.75 | 2012 | 1 | 4.27 | 110 | 31.75 | 2012 | 2 | 15.26 | |
| 95 | 390.7 | 384.1 | 110 | 31.75 | 2012 | 1 | 6.88 | 110 | 31.75 | 2012 | 2 | 19.08 | |
| 114 | 467.4 | 460.9 | 110 | 44.45 | 2012/2517 | 1 | 10.44 | 110 | 31.75 | 2517 | 2 | 22.90 | |

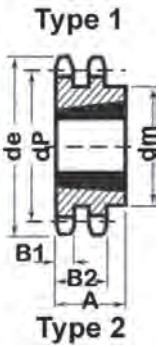

| | |
|-----------------|------|
| Pinions | mm |
| Tooth Radius r3 | |
| Radius Width C | |
| Tooth Width B1 | 7.2 |
| Chain | mm |
| Pitch | 12.7 |
| Inside | 7.75 |
| Roller ø | 8.51 |

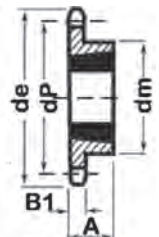
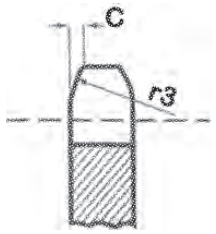

| 10B-1-2 Taper Lock | | Teeth | de | dp | Simplex | | | | Duplex | | | | |
|--------------------|-------|-------|-----|-------|-----------|---|-------|------|---------|-----------|---|------|------|
| | | | | | dm | A | Bush | Type | App. Kg | dm | A | Bush | Type |
| 12 | 68.2 | 61.34 | 47 | 22.23 | 1008 | 1 | 0.20 | - | - | - | - | - | - |
| 13 | 73.2 | 66.32 | 47 | 22.23 | 1008 | 1 | 0.23 | - | - | - | - | - | - |
| 14 | 78 | 71.34 | 52 | 22 | 1108 | 1 | | - | - | - | - | - | - |
| 15 | 83.2 | 76.36 | 60 | 25.40 | 1210 | 1 | 0.32 | - | 25.4 | 1210 | 3 | 0.48 | |
| 16 | 88.3 | 81.37 | 71 | 25.40 | 1210/1610 | 1 | 0.37 | - | 25.4 | 1610 | 3 | 0.48 | |
| 17 | 93.3 | 86.39 | 71 | 25.40 | 1610 | 1 | 0.41 | - | 25.4 | 1610 | 3 | 0.57 | |
| 18 | 98.3 | 91.42 | 75 | 25.40 | 1610 | 1 | 0.51 | - | 25.4 | 1610 | 3 | 0.57 | |
| 19 | 103.3 | 96.45 | 75 | 25.40 | 1610 | 1 | 0.64 | - | 25.4 | 1610 | 3 | 0.71 | |
| 20 | 108.4 | 101.5 | 75 | 25.40 | 1610 | 1 | 0.68 | - | 25.4 | 1610 | 3 | 0.71 | |
| 21 | 113.4 | 106.5 | 76 | 25.40 | 1610 | 1 | 0.73 | - | 25.4 | 1610 | 3 | 0.86 | |
| 22 | 118.4 | 111.6 | 76 | 25.40 | 1610 | 1 | 0.78 | - | 25.4 | 1610 | 3 | 0.86 | |
| 23 | 123.5 | 116.6 | 76 | 25.40 | 1610 | 1 | 0.82 | - | 25.4 | 1610 | 3 | 0.98 | |
| 24 | 128.5 | 121.6 | 90 | 25.40 | 1610/2012 | 1 | 0.91 | 90 | 31.75 | 2012 | 2 | 0.98 | |
| 25 | 133.6 | 126.7 | 90 | 31.75 | 2012 | 1 | 1.09 | 90 | 31.75 | 2012 | 2 | 3.40 | |
| 26 | 138.6 | 131.7 | 90 | 31.75 | 2012 | 1 | 1.14 | 90 | 31.75 | 2012 | 2 | 0.98 | |
| 27 | 143.6 | 136.8 | 90 | 31.75 | 2012 | 1 | 1.18 | 90 | 31.75 | 2012 | 2 | 3.50 | |
| 28 | 148.7 | 141.8 | 90 | 31.75 | 2012 | 1 | 1.29 | 90 | 31.75 | 2012 | 2 | 0.98 | |
| 29 | 153.8 | 146.8 | 90 | 31.75 | 2012 | 1 | | 90 | 31.75 | 2012 | 2 | | |
| 30 | 158.8 | 151.9 | 90 | 31.75 | 2012 | 1 | 1.41 | 90 | 31.75 | 2012 | 2 | 3.92 | |
| 32 | 168.9 | 162 | 90 | 31.75 | 2012 | 1 | 1.63 | - | - | - | - | - | - |
| 33 | 174.5 | 167 | 90 | 31.75 | 2012 | 1 | | - | - | - | - | - | - |
| 35 | 184.1 | 177.1 | 90 | 31.75 | 2012 | 1 | | - | - | - | - | - | - |
| 36 | 189.1 | 182.2 | 90 | 31.75 | 2012 | 1 | | - | - | - | - | - | - |
| 38 | 199.1 | 192.2 | 90 | 31.75 | 2012 | 1 | 2.22 | 90 | 31.75 | 2012 | 2 | 5.68 | |
| 40 | 209.3 | 202.3 | 90 | 31.75 | 2012 | 1 | | - | - | - | - | - | - |
| 45 | 236 | 227.6 | 90 | 31.75 | 2012 | 1 | 2.95 | - | - | - | - | - | - |
| 48 | 251.1 | 242.7 | 90 | 31.75 | 2012 | 1 | 3.25 | - | - | - | - | - | - |
| 57 | 296.6 | 288.2 | 90 | 31.75 | 2012 | 1 | 4.59 | 110 | 44 | 2517/3020 | 2 | 0.98 | |
| 76 | 392.5 | 384.2 | 110 | 31.75 | 2012 | 1 | 8.31 | 110 | 44 | 2517/3020 | 2 | 0.98 | |
| 95 | 488.5 | 480.1 | 110 | 44.45 | 2517 | 1 | 12.76 | - | - | - | - | - | - |
| 114 | 584.5 | 576.1 | 110 | 44.75 | 2517 | 1 | | - | - | - | - | - | - |

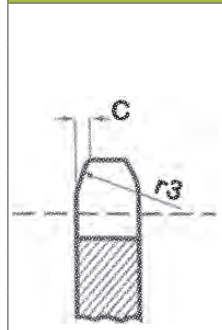

| | |
|-----------------|------|
| Pinions | mm |
| Tooth Radius r3 | |
| Radius Width C | |
| Tooth Width B1 | 9.1 |
| Chain | mm |
| Pitch | 5.88 |
| Inside | 9.65 |
| Roller ø | 10.2 |

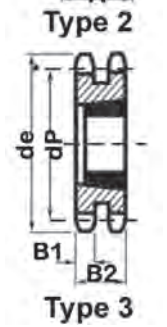
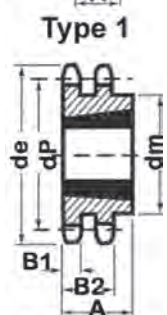
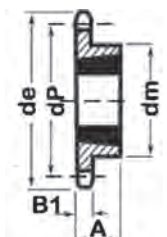

"Why compete against your supplier when you can be our partner"

| 12B-1-2-3 Taper Lock | | Teeth | de | dp | dm | A | Bush | Type | App. Kg | dm | A | Bush | Type | App. Kg | dm | A | Bush | Type | App. Kg | |
|----------------------|---------|-------|-------|-------|------|-------|-----------|------|---------|------|-------|-----------|------|---------|------|------|-----------|------|---------|----|
| | | 12 | 815 | 736 | 60 | 244 | 1210 | 1 | OA | - | - | - | - | - | - | - | - | - | - | - |
| | | 13 | 878 | 7959 | 60 | 2540 | 1210 | 1 | 041 | OA | 254 | 1210 | OA | OA | - | - | - | - | - | - |
| | | 14 | 936 | 8561 | 70 | 2540 | 1610 | 1 | OA | - | - | - | - | - | - | - | - | - | - | - |
| | | 15 | 998 | 9163 | 70 | 2540 | 1610 | 1 | 054 | - | 30.10 | 1610 | 3 | 090 | - | 498 | 1615 | 5 | OA | - |
| | | 16 | 1055 | 9765 | 75 | 2540 | 1610 | 1 | OA | - | 30.10 | 1610 | 3 | OA | - | - | - | - | - | - |
| | | 17 | 1119 | 1037 | 76 | 2540 | 1610 | 1 | 082 | - | 30.10 | 1610/1615 | 3 | 1.25 | - | 498 | 1615/2017 | 5 | OA | - |
| | | 18 | 1179 | 1097 | 90 | 31.75 | 1610/2012 | 1 | 091 | 90 | 31.75 | 2012 | 2 | OA | - | - | - | - | - | - |
| | | 19 | 1239 | 1158 | 90 | 31.75 | 2012 | 1 | 1.00 | 90 | 31.75 | 2012 | 2 | 1.81 | - | 498 | 2012 | 5 | OA | - |
| | | 20 | 130 | 1218 | 90 | 44.45 | 2012 | 1 | 1.00 | 108 | 44.45 | 2517 | 2 | OA | - | - | - | - | - | - |
| | | 21 | 136 | 1278 | 102 | 44.45 | 2517 | 1 | 1.18 | 108 | 44.45 | 2517 | 2 | 2.50 | - | 498 | 2517 | 5 | OA | - |
| | | 22 | 142 | 1339 | 102 | 44.45 | 2517 | 1 | 1.27 | 108 | 44.45 | 2517 | 2 | OA | - | - | - | - | - | - |
| | Pinions | mm | 23 | 1481 | 1399 | 108 | 44.45 | 2517 | 1 | 1.37 | 108 | 44.45 | 2517 | 2 | 3.07 | - | 498 | 2517 | 5 | OA |
| Tooth Radius r3 | | 24 | 154.1 | 1459 | 108 | 44.45 | 2517 | 1 | 1.50 | 108 | 44.45 | 2517 | 2 | OA | - | - | - | - | - | - |
| Radius Width C | | 25 | 160.2 | 152 | 108 | 44.45 | 2517 | 1 | 1.74 | 108 | 44.45 | 2517 | 2 | 3.63 | - | 498 | 2517 | 5 | OA | - |
| Tooth Width B1 | 11.1 | 26 | 165.9 | 158 | 108 | 44.45 | 2517 | 1 | OA | 108 | 44.45 | 2517 | 2 | OA | - | - | - | - | - | - |
| | | 27 | 172.3 | 164.1 | 108 | 44.45 | 2517 | 1 | 1.80 | 108 | 44.45 | 2517 | 2 | 4.20 | 140 | 5080 | 3020 | 4 | OA | - |
| Chain | mm | 28 | 178 | 170 | 108 | 44.45 | 2517 | 1 | OA | 108 | 44.45 | 2517 | 2 | OA | - | - | - | - | - | - |
| Pitch | 19.05 | 29 | 184.1 | 176.2 | 108 | 44.45 | 2517 | 1 | OA | 108 | 44.45 | 2517 | 2 | OA | - | - | - | - | - | - |
| Inside | 11.68 | 30 | 190.4 | 182.3 | 108 | 44.45 | 2517 | 1 | 2.32 | 140 | 5080 | 2517 | 2 | 5.04 | 140 | 5080 | 3020 | 4 | OA | - |
| Roller ϕ | 12.07 | 32 | 202.5 | 194.4 | 108 | 44.45 | 2517 | 1 | 2.48 | OA | OA | 2517 | OA | OA | - | - | - | - | - | - |
| | | 34 | 214.6 | 206.5 | 108 | 44.45 | 2517 | 1 | OA | - | - | - | - | - | - | - | - | - | - | - |
| | | 35 | 221 | 212.5 | 108 | 44.45 | 2517 | 1 | OA | - | - | - | - | - | - | - | - | - | - | - |
| | | 36 | 226.8 | 218.6 | 108 | 44.45 | 2517 | 1 | OA | - | - | - | - | - | - | - | - | - | - | - |
| | | 38 | 238.9 | 230.1 | 108 | 44.45 | 2517 | 1 | 3.36 | 140 | 5080 | 3020 | 2 | 8.40 | 140 | 5080 | 3020 | 4 | OA | - |
| | | 45 | 283.2 | 273.1 | 108 | 44.45 | 2517 | 1 | 3.98 | 140 | 5080 | 3020 | 2 | - | - | - | - | - | - | |
| | | 57 | 355.9 | 345.8 | 108 | 44.45 | 2517 | 1 | 8.76 | 140 | 5080 | 3020 | 2 | 19.48 | 160 | 5080 | 3020 | 4 | OA | - |
| | | 76 | 471.1 | 461 | 108 | 44.45 | 2517 | 1 | 11.68 | 140 | 5080 | 3020 | 2 | 29.52 | 160 | 5080 | 3020 | 4 | OA | - |
| | | 95 | 586.2 | 576.2 | 108 | 44.45 | 2517 | 1 | 14.60 | 140 | 5080 | 3020 | 2 | 34.40 | - | - | - | - | - | |
| | | 114 | 701.4 | 691.4 | 140 | 50.80 | 3020 | 1 | 17.52 | 160 | 76.20 | 3030 | 2 | 39.28 | - | - | - | - | - | |

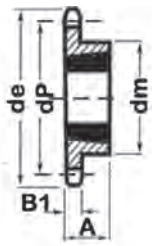

Type 1

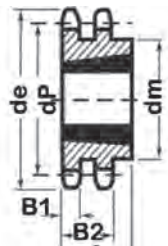

Type 2

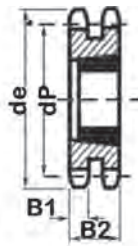

Type 3

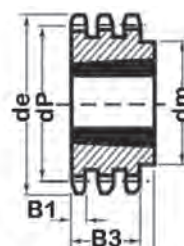

Type 4

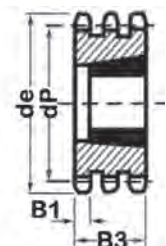

Type 5

British Standard Taper Locks



"Australia's Only Genuine Wholesaler"

| 16B-1-2-3 Taper Lock | | Teeth | de | dp | dm | A | Bush | Type | App. Kg | dm | A | Bush | Type | App. Kg | dm | A | Bush | Type |
|----------------------|-------|-------|-------|-------|-----|-------|-----------|------|---------|-----|-------------|-----------|------|---------|-----|------|-----------|------|
| | | 12 | 109 | 98.14 | 73 | 25.4 | 1610 | 1 | OA | - | - | - | - | - | - | - | - | - |
| | | 13 | 117.7 | 106.1 | 73 | 38.10 | 1610/1615 | 1 | 1.27 | OA | 47.7 | 2012 | OA | OA | - | - | - | - |
| | | 14 | 125 | 114 | 76 | 38.10 | 1610 | 1 | OA | - | - | - | - | - | - | - | - | - |
| | | 15 | 133.7 | 122.2 | 76 | 38.10 | 1610/1615 | 1 | 1.45 | - | 47.7 | 2012 | 3 | 2.04 | - | 47.7 | 2012 | 5 |
| | | 16 | 141.8 | 130.2 | 76 | 38.10 | 1615/2012 | 1 | 1.55 | - | 47.7 | 2517 | 3 | OA | - | - | - | - |
| | | 17 | 149.8 | 138.2 | 90 | 32 | 2012/2517 | 1 | 1.69 | - | 47.7 | 2517 | 3 | 2.50 | - | 79.6 | 2517 | 5 |
| | | 18 | 157.8 | 146.3 | 108 | 44.45 | 2517 | 1 | 1.46 | - | 47.7 | 2517 | 3 | OA | - | - | - | - |
| | | 19 | 165.9 | 154.4 | 108 | 44.45 | 2517 | 1 | 2.14 | - | 47.7 | 2517 | 3 | 3.18 | - | 79.6 | 3030 | 5 |
| | | 20 | 173.9 | 162.4 | 108 | 44.45 | 2517 | 1 | 2.72 | - | 47.7 | 2517 | 3 | OA | - | - | - | - |
| | | 21 | 182 | 170.4 | 110 | 44.45 | 2517 | 1 | 2.95 | 140 | 50.80 | 3020 | 2 | 2.95 | - | 79.6 | 3030/3535 | 5 |
| Pinions | mm | 22 | 190.1 | 178.5 | 110 | 44.45 | 2517 | 1 | 3.18 | 140 | 50.80 | 3020 | 2 | OA | - | - | - | - |
| Tooth Radius r3 | | 23 | 198.1 | 186.5 | 110 | 44.45 | 2517 | 1 | 3.40 | 140 | 50.80 | 3020 | 2 | 5.48 | - | 89 | 3525/3535 | 5 |
| Radius Width C | | 24 | 206.2 | 194.6 | 110 | 44.45 | 2517 | 1 | 3.63 | 140 | 50.80 | 3020 | 2 | OA | - | - | - | - |
| Tooth Width B1 | 16.2 | 25 | 214.2 | 202.7 | 110 | 44.45 | 2517 | 1 | 3.90 | 140 | 50.80 | 3020 | 2 | 7.72 | - | 89 | 3535 | 5 |
| | | 26 | 221.6 | 210.7 | 110 | 44.45 | 2517 | 1 | OA | 140 | 50.80 | 3020 | 2 | OA | - | - | - | - |
| Chain | mm | 27 | 230.4 | 218.8 | 110 | 44.45 | 2517 | 1 | 4.31 | 140 | 50.80 | 3020 | 2 | 10.22 | - | 89 | 3535 | 5 |
| Pitch | 25.4 | 28 | 237.7 | 226.8 | 110 | 44.45 | 2517 | 1 | OA | 140 | 50.80 | 3020 | 2 | OA | - | - | - | - |
| Inside | 17.02 | 29 | 245.8 | 234.9 | 120 | 44.45 | 2517/3020 | 1 | OA | 140 | 50.80 | 3020 | 2 | OA | - | - | - | - |
| Roller ø | 15.88 | 30 | 254.6 | 243 | 120 | 44.45 | 2517/3020 | 1 | 5.44 | 140 | 50.80/76.20 | 3020/3030 | 2 | 11.35 | 175 | 89 | 3525/3535 | 4 |
| | | 32 | 270.7 | 259.1 | 140 | 50.8 | 3020 | 1 | OA | - | - | - | - | - | - | - | - | - |
| | | 33 | 278.5 | 267.2 | 140 | 50.8 | 3020 | 1 | OA | - | - | - | - | - | - | - | - | - |
| | | 35 | 294.9 | 283.4 | 140 | 50.80 | 3020 | 1 | 7.12 | - | - | - | - | - | - | - | - | |
| | | 38 | 319.2 | 307.6 | 140 | 50.80 | 3020 | 1 | 8.85 | 160 | 76.20 | 3020/3030 | 2 | 21.79 | 178 | 89 | 3535 | 4 |
| | | 45 | 377.9 | 364.1 | 140 | 50.80 | 2517/3020 | 1 | 12.25 | OA | 76.2 | 3020 | OA | OA | - | - | - | - |
| | | 57 | 474.9 | 461.1 | 140 | 50.80 | 3020 | 1 | 19.16 | 175 | 86.90 | 3525 | 2 | 27.24 | 216 | 102 | 4040 | 4 |
| | | 76 | 628.4 | 614.7 | 140 | 50.80 | 3020 | 1 | 28.55 | 175 | 86.90 | 3535 | 2 | 37.68 | 216 | 102 | 4030/4040 | 4 |
| | | 95 | 782 | 768.2 | 140 | 50.80 | 3020 | 1 | 41.58 | - | - | - | - | - | - | - | - | |
| | | 114 | 935.6 | 921.8 | 140 | 50.80 | 3030 | 1 | 56.15 | - | - | - | - | - | - | - | - | |

| | | | | |
|----------------------|----------------------|----------------------|----------------------|----------------------|
| <p>Type 1</p> | <p>Type 2</p> | <p>Type 3</p> | <p>Type 4</p> | <p>Type 5</p> |
|----------------------|----------------------|----------------------|----------------------|----------------------|