

06B-1-2 Taper Lock

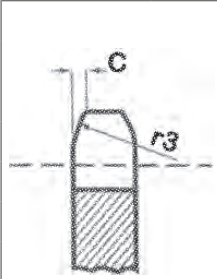

Pinions	mm
Tooth Radius r3	
Radius Width C	
Tooth Width B1	5.3
Chain	mm
Pitch	9.53
Inside	5.72
Roller ϕ	6.35

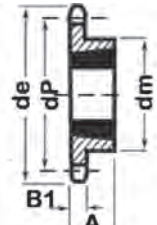

Type 1

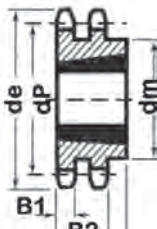

Type 2

Teeth	de	dp	Simplex					Duplex				
			dm	A	Bush	Type	App. Kg	dm	A	Bush	Type	App. Kg
17	55.5	51.83	45	22.23	1008	1	0.14	41	22	1008	2	0.5
18	58.6	54.85	45	22.23	1008	1	0.18	43	22	1008	2	0A
19	61.6	57.87	45	22.23	1008	1	0.23	46	22	1008	2	0.6
20	64.6	60.89	45	22.23	1008	1	0.27	48	22	1008	2	0A
21	67.6	63.91	45	22.23	1008	1	0.32	49	22	1008	2	1.4
22	70.6	66.93	45	22.23	1108	1	0.36	52	22	1008	2	0A
23	73.7	69.95	63	25.40	1210	1	0.41	59	25	1210	2	1.8
24	76.7	72.97	63	25.40	1210	1	0.45	61	25	1210	2	0A
25	79.7	76	63	25.40	1210	1	0.54	64	25	1210	2	1.9
26	83.0	79.02	63	25.40	1210	1	0.53	64	25	1210	2	1.95
27	85.7	82.04	63	25.40	1210	1	0.52	70	25	1210	2	2.0
28	89	85.07	63	25.4	1210	1	0.53	70	25	1210	2	0A
29	92	88.09	63	25.4	1210	1	0.53	70	25	1210	2	0A
30	94.8	91.12	63	25.40	1210	1	0.54	75	25	1210	2	2.1
36	113.4	109.3	-	-	-	-	-	75	25	1210	2	0A
38	119	115.3	70	25.40	1210	1	0.68	80	25	1610	2	2.5
45	118.6	114.7	70	25.40	1210	1	0.95	-	-	-	-	-
57	149.3	145.2	83	25.40	1210	1	1.25	80	25	1610	2	4.1
76	197.9	193.6	83	25.40	1210	1	1.82	80	25	1615	2	6.8
95	246.3	242	83	25.40	1210	1	2.28	90	25	1615	2	6.9
114	294.8	290.3	83	38	1215	1	0A	-	-	-	-	-



"Why compete against your supplier when you can be our partner"

08B-1-2 Taper Lock		Teeth	de	dp	Simplex				Duplex				
					dm	A	Bush	Type	App. Kg	dm	A	Bush	Type
14	61.9	57.07	45	22.23	1008	1	0.18	-	-	-	-	-	
15	65.9	61.09	45	22.23	1008	1	0.18	46	22.23	1008	2	0.18	
16	69.9	65.1	45	22.23	1008/1108	1	0.23	50	22	1008	2	0A	
17	74	69.11	60	25.40	1108/1210	1	0.23	56	25.40	1210	2	0.27	
18	78	73.14	62	25.40	1210	1	0.27	60	25	1210	2	0A	
19	82	77.16	63	25.40	1210	1	0.32	62	25.40	1210	2	0.36	
20	86	81.19	71	25.40	1210/1610	1	0.41	66	25	1610	2	0A	
21	90.1	85.22	71	25.40	1610	1	0.45	70	25.40	1610	2	0.46	
22	94.1	89.24	71	25.40	1610	1	0.50	76	25	1610	2	0A	
23	98.1	93.27	76	25.40	1610	1	0.59	79	25.40	1610	2	0.59	
24	102.1	97.29	76	25.40	1610	1	0.73	84	25	2012	2	0A	
25	106.2	101.3	76	25.40	1610	1	0.74	87	31.75	2012	2	0.77	
26	110.2	105.4	76	25.40	1610	1	0.76	87	32	2012	2	0A	
27	114.2	109.4	76	25.40	1610	1	0.78	87	31.75	2012	2	0.95	
28	118.3	113.4	76	25.40	2012	1	0.80	87	32	2012	2	0A	
29	112.3	117.5	76	25.40	2012	1	0.81	87	32	2012	2	0A	
30	126.3	121.5	90	31.75	2012	1	0.82	87	32	2012	2	1.59	
32	134.4	129.6	90	31.75	2012	1	0.87	-	-	-	-	-	
35	146.5	141.7	9.0	31.5	2012	1	0.95	-	-	-	-	-	
37	151.0	145.7	-	-	-	-	-	87	32	2012	2	2.85	
38	158.6	153.8	90	31.75	2012	1	1.23	100	32	2012	2	3.18	
45	188.6	182.1	100	31.75	2012	1	1.46	100	32	2012	2	3.95	
48	200.7	194.2	100	31.75	2012	1	1.55	-	-	-	-	-	
50	208.8	202.3	110	31.75	2012	1	0A	-	-	-	-	-	
57	233.1	230.5	110	31.75	2012	1	2.60	110	31.75	2012	2	7.56	
76	313.9	307.3	110	31.75	2012	1	4.27	110	31.75	2012	2	15.26	
95	390.7	384.1	110	31.75	2012	1	6.88	110	31.75	2012	2	19.08	
114	467.4	460.9	110	44.45	2012/2517	1	10.44	110	31.75	2517	2	22.90	

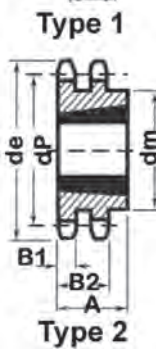
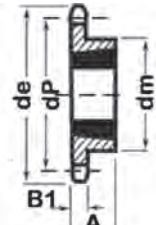
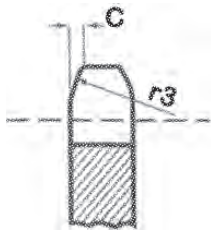

Pinions	mm
Tooth Radius r3	
Radius Width C	
Tooth Width B1	7.2
Chain	mm
Pitch	12.7
Inside	7.75
Roller ø	8.51



10B-1-2 Taper Lock		Teeth	de	dp	Simplex				Duplex				
					dm	A	Bush	Type	App. Kg	dm	A	Bush	Type
12	68.2	61.34	47	22.23	1008	1	0.20	-	-	-	-	-	
13	73.2	66.32	47	22.23	1008	1	0.23	-	-	-	-	-	
14	78	71.34	52	22	1108	1		-	-	-	-	-	
15	83.2	76.36	60	25.40	1210	1	0.32	-	25.4	1210	3	0.48	
16	88.3	81.37	71	25.40	1210/1610	1	0.37	-	25.4	1610	3	0.48	
17	93.3	86.39	71	25.40	1610	1	0.41	-	25.4	1610	3	0.57	
18	98.3	91.42	75	25.40	1610	1	0.51	-	25.4	1610	3	0.57	
19	103.3	96.45	75	25.40	1610	1	0.64	-	25.4	1610	3	0.71	
20	108.4	101.5	75	25.40	1610	1	0.68	-	25.4	1610	3	0.71	
21	113.4	106.5	76	25.40	1610	1	0.73	-	25.4	1610	3	0.86	
22	118.4	111.6	76	25.40	1610	1	0.78	-	25.4	1610	3	0.86	
23	123.5	116.6	76	25.40	1610	1	0.82	-	25.4	1610	3	0.98	
24	128.5	121.6	90	25.40	1610/2012	1	0.91	90	31.75	2012	2	0.98	
25	133.6	126.7	90	31.75	2012	1	1.09	90	31.75	2012	2	3.40	
26	138.6	131.7	90	31.75	2012	1	1.14	90	31.75	2012	2	0.98	
27	143.6	136.8	90	31.75	2012	1	1.18	90	31.75	2012	2	3.50	
28	148.7	141.8	90	31.75	2012	1	1.29	90	31.75	2012	2	0.98	
29	153.8	146.8	90	31.75	2012	1		90	31.75	2012	2		
30	158.8	151.9	90	31.75	2012	1	1.41	90	31.75	2012	2	3.92	
32	168.9	162	90	31.75	2012	1	1.63	-	-	-	-	-	
33	174.5	167	90	31.75	2012	1		-	-	-	-	-	
35	184.1	177.1	90	31.75	2012	1		-	-	-	-	-	
36	189.1	182.2	90	31.75	2012	1		-	-	-	-	-	
38	199.1	192.2	90	31.75	2012	1	2.22	90	31.75	2012	2	5.68	
40	209.3	202.3	90	31.75	2012	1		-	-	-	-	-	
45	236	227.6	90	31.75	2012	1	2.95	-	-	-	-	-	
48	251.1	242.7	90	31.75	2012	1	3.25	-	-	-	-	-	
57	296.6	288.2	90	31.75	2012	1	4.59	110	44	2517/3020	2	0.98	
76	392.5	384.2	110	31.75	2012	1	8.31	110	44	2517/3020	2	0.98	
95	488.5	480.1	110	44.45	2517	1	12.76	-	-	-	-	-	
114	584.5	576.1	110	44.75	2517	1		-	-	-	-	-	

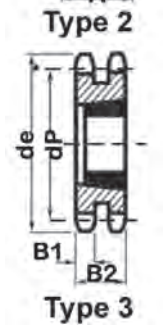
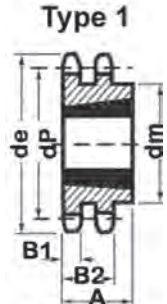
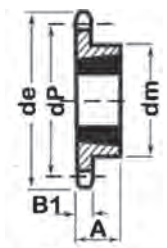
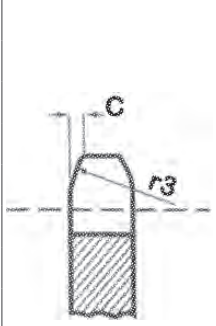

Pinions	mm
Tooth Radius r3	
Radius Width C	
Tooth Width B1	9.1
Chain	mm
Pitch	5.88
Inside	9.65
Roller ø	10.2

"Why compete against your supplier when you can be our partner"

12B-1-2-3 Taper Lock		Teeth	de	dp	dm	A	Bush	Type	App. Kg	dm	A	Bush	Type	App. Kg	dm	A	Bush	Type	App. Kg	
		12	815	736	60	244	1210	1	OA	-	-	-	-	-	-	-	-	-	-	-
		13	878	7959	60	2540	1210	1	041	OA	254	1210	OA	OA	-	-	-	-	-	-
		14	936	8561	70	2540	1610	1	OA	-	-	-	-	-	-	-	-	-	-	-
		15	998	9163	70	2540	1610	1	054	-	30.10	1610	3	090	-	498	1615	5	OA	-
		16	1055	9765	75	2540	1610	1	OA	-	30.10	1610	3	OA	-	-	-	-	-	-
		17	1119	1037	76	2540	1610	1	082	-	30.10	1610/1615	3	1.25	-	498	1615/2017	5	OA	-
		18	1179	1097	90	31.75	1610/2012	1	091	90	31.75	2012	2	OA	-	-	-	-	-	-
		19	1239	1158	90	31.75	2012	1	1.00	90	31.75	2012	2	1.81	-	498	2012	5	OA	-
		20	130	1218	90	44.45	2012	1	1.00	108	44.45	2517	2	OA	-	-	-	-	-	-
		21	136	1278	102	44.45	2517	1	1.18	108	44.45	2517	2	2.50	-	498	2517	5	OA	-
		22	142	1339	102	44.45	2517	1	1.27	108	44.45	2517	2	OA	-	-	-	-	-	-
	Pinions	mm	23	1481	1399	108	44.45	2517	1	1.37	108	44.45	2517	2	3.07	-	498	2517	5	OA
Tooth Radius r3		24	154.1	1459	108	44.45	2517	1	1.50	108	44.45	2517	2	OA	-	-	-	-	-	-
Radius Width C		25	160.2	152	108	44.45	2517	1	1.74	108	44.45	2517	2	3.63	-	498	2517	5	OA	-
Tooth Width B1	11.1	26	165.9	158	108	44.45	2517	1	OA	108	44.45	2517	2	OA	-	-	-	-	-	-
		27	172.3	164.1	108	44.45	2517	1	1.80	108	44.45	2517	2	4.20	140	5080	3020	4	OA	-
Chain	mm	28	178	170	108	44.45	2517	1	OA	108	44.45	2517	2	OA	-	-	-	-	-	-
Pitch	19.05	29	184.1	176.2	108	44.45	2517	1	OA	108	44.45	2517	2	OA	-	-	-	-	-	-
Inside	11.68	30	190.4	182.3	108	44.45	2517	1	2.32	140	5080	2517	2	5.04	140	5080	3020	4	OA	-
Roller ϕ	12.07	32	202.5	194.4	108	44.45	2517	1	2.48	OA	OA	2517	OA	OA	-	-	-	-	-	-
		34	214.6	206.5	108	44.45	2517	1	OA	-	-	-	-	-	-	-	-	-	-	-
		35	221	212.5	108	44.45	2517	1	OA	-	-	-	-	-	-	-	-	-	-	-
		36	226.8	218.6	108	44.45	2517	1	OA	-	-	-	-	-	-	-	-	-	-	-
		38	238.9	230.1	108	44.45	2517	1	3.36	140	5080	3020	2	8.40	140	5080	3020	4	OA	-
		45	283.2	273.1	108	44.45	2517	1	3.98	140	5080	3020	2	-	-	-	-	-	-	
		57	355.9	345.8	108	44.45	2517	1	8.76	140	5080	3020	2	19.48	160	5080	3020	4	OA	-
		76	471.1	461	108	44.45	2517	1	11.68	140	5080	3020	2	29.52	160	5080	3020	4	OA	-
		95	586.2	576.2	108	44.45	2517	1	14.60	140	5080	3020	2	34.40	-	-	-	-	-	
		114	701.4	691.4	140	50.80	3020	1	17.52	160	76.20	3030	2	39.28	-	-	-	-	-	

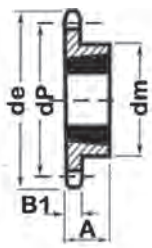

Type 1

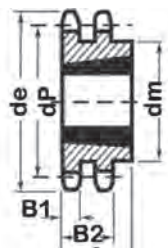

Type 2

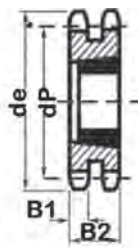

Type 3

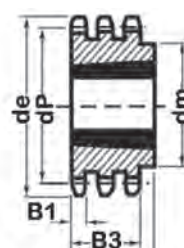

Type 4

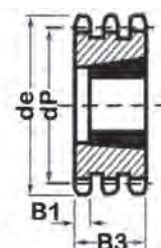

Type 5

British Standard Taper Locks



"Australia's Only Genuine Wholesaler"

16B-1-2-3 Taper Lock		Teeth	de	dp	dm	A	Bush	Type	App. Kg	dm	A	Bush	Type	App. Kg	dm	A	Bush	Type		
		12	109	98.14	73	25.4	1610	1	OA	-	-	-	-	-	-	-	-	-	-	
		13	117.7	106.1	73	38.10	1610/1615	1	1.27	OA	47.7	2012	OA	OA	-	-	-	-	-	
		14	125	114	76	38.10	1610	1	OA	-	-	-	-	-	-	-	-	-	-	-
		15	133.7	122.2	76	38.10	1610/1615	1	1.45	-	47.7	2012	3	2.04	-	47.7	2012	5	-	-
		16	141.8	130.2	76	38.10	1615/2012	1	1.55	-	47.7	2517	3	OA	-	-	-	-	-	-
		17	149.8	138.2	90	32	2012/2517	1	1.69	-	47.7	2517	3	2.50	-	79.6	2517	5	-	-
		18	157.8	146.3	108	44.45	2517	1	1.46	-	47.7	2517	3	OA	-	-	-	-	-	-
		19	165.9	154.4	108	44.45	2517	1	2.14	-	47.7	2517	3	3.18	-	79.6	3030	5	-	-
		20	173.9	162.4	108	44.45	2517	1	2.72	-	47.7	2517	3	OA	-	-	-	-	-	-
		21	182	170.4	110	44.45	2517	1	2.95	140	50.80	3020	2	2.95	-	79.6	3030/3535	5	-	-
Pinions	mm	22	190.1	178.5	110	44.45	2517	1	3.18	140	50.80	3020	2	OA	-	-	-	-	-	
Tooth Radius r3		23	198.1	186.5	110	44.45	2517	1	3.40	140	50.80	3020	2	5.48	-	89	3525/3535	5	-	
Radius Width C		24	206.2	194.6	110	44.45	2517	1	3.63	140	50.80	3020	2	OA	-	-	-	-	-	
Tooth Width B1	16.2	25	214.2	202.7	110	44.45	2517	1	3.90	140	50.80	3020	2	7.72	-	89	3535	5	-	
		26	221.6	210.7	110	44.45	2517	1	OA	140	50.80	3020	2	OA	-	-	-	-	-	
Chain	mm	27	230.4	218.8	110	44.45	2517	1	4.31	140	50.80	3020	2	10.22	-	89	3535	5	-	
Pitch	25.4	28	237.7	226.8	110	44.45	2517	1	OA	140	50.80	3020	2	OA	-	-	-	-	-	
Inside	17.02	29	245.8	234.9	120	44.45	2517/3020	1	OA	140	50.80	3020	2	OA	-	-	-	-	-	
Roller ø	15.88	30	254.6	243	120	44.45	2517/3020	1	5.44	140	50.80/76.20	3020/3030	2	11.35	175	89	3525/3535	4	-	
		32	270.7	259.1	140	50.8	3020	1	OA	-	-	-	-	-	-	-	-	-	-	
		33	278.5	267.2	140	50.8	3020	1	OA	-	-	-	-	-	-	-	-	-	-	
		35	294.9	283.4	140	50.80	3020	1	7.12	-	-	-	-	-	-	-	-	-	-	
		38	319.2	307.6	140	50.80	3020	1	8.85	160	76.20	3020/3030	2	21.79	178	89	3535	4	-	
		45	377.9	364.1	140	50.80	2517/3020	1	12.25	OA	76.2	3020	OA	OA	-	-	-	-	-	
		57	474.9	461.1	140	50.80	3020	1	19.16	175	86.90	3525	2	27.24	216	102	4040	4	-	
		76	628.4	614.7	140	50.80	3020	1	28.55	175	86.90	3535	2	37.68	216	102	4030/4040	4	-	
		95	782	768.2	140	50.80	3020	1	41.58	-	-	-	-	-	-	-	-	-	-	
		114	935.6	921.8	140	50.80	3030	1	56.15	-	-	-	-	-	-	-	-	-	-	

<p>Type 1</p>	<p>Type 2</p>	<p>Type 3</p>	<p>Type 4</p>	<p>Type 5</p>
----------------------	----------------------	----------------------	----------------------	----------------------

"Why compete against your supplier when you can be our partner"

20B-1 Taper Lock		Teeth	de	dp	Simplex			Type
					dm	A	Bush	
		9	106.5	92.84	63	40	2012	1
		10	117	102.7	70	40	2012	1
		11	127	112.7	77	45	2517	1
		12	137	122.7	88	45	2517	1
		13	147.5	132.7	98	45	2517	1
		14	157.6	142.7	108	45	2517	1
		15	167.6	152.7	118	45	2517	1
		16	177.7	162.8	120	50	2517	1
		17	187.8	172.8	120	50	2517	1
		18	197.8	182.9	120	50	2517	1
		19	207.9	192.9	120	50	2517	1
		20	217.9	203	120	50	2517	1
		21	228	213	140	55	2517	1
		22	238.1	223.1	140	55	2517	1
		23	248.2	233.2	140	55	2517	1
		24	258.3	243.2	140	55	2517	1
		25	268.4	253.3	140	55	2517	1
		26	278.4	263.4	150	55	2517	1
		27	288.5	273.5	150	55	3020	1
		28	299	283.6	150	55	3020	1
		29	308.8	293.6	150	55	3020	1
		30	319	303.8	150	55	3020	1
		38	399.6	384.5	160	55	3020	1

24B-1 Taper Lock		Teeth	de	dp	Simplex			Type
					dm	A	Bush	
		19	246.5	231.49	133.4	50.8	3020	1
		23	294.8	279.8	133.4	50.8	3020	1